

Dudley

# NIAGARA

Dual / Single Flush Pushbutton Valve

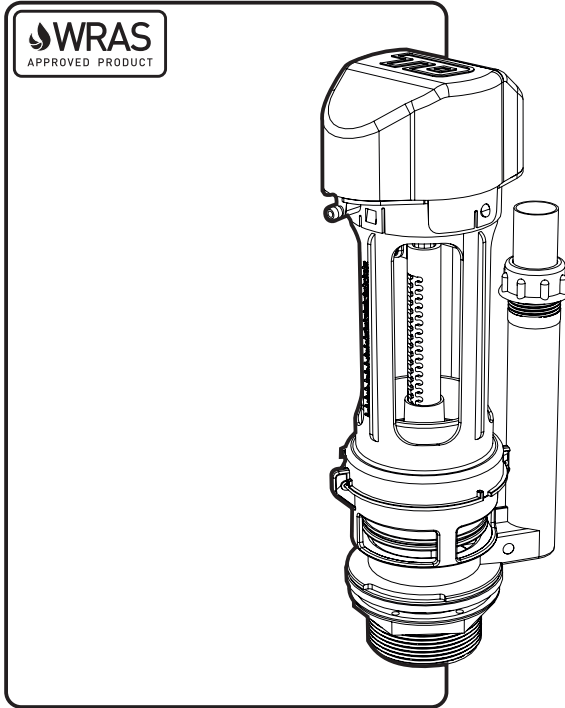

## Installation Instructions

The Niagara Pneumatic can be fitted as a replacement into Dudley Vantage, Miniflo & Royal Pushflo concealed cisterns.

It can also be fitted into most other concealed cisterns if used only in conjunction with a Dudley sensor, pushbutton or push plate.

To use the Niagara in dual flush mode, it must be used in conjunction with a Dudley sensor, dual flush button or push plate.



Thomas Dudley Ltd  
P.O.Box 28, Birmingham New Road, Dudley, West Midlands, DY1 4SN  
Telephone: 0121 557 5411  
Email: sales@thomasdudley.co.uk

# Instructions: Niagara Pneumatic Dual / Single Flush Valve

## 1 PACK CONTENTS

1. Niagara pneumatic dual/single flush
2. Overflow assembly
3. Sealing washer
4. Back nut
5. Cap nut
6. Slip ring
7. Cone ring
8. White tube
9. Green tube

**Important:** The Niagara flush valve can operate both dual flush and single flush.

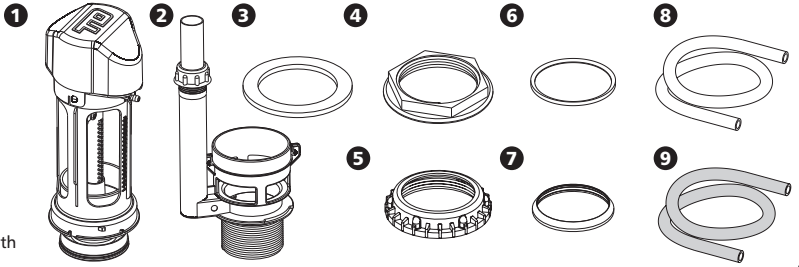

## 2 FITTING THE NIAGARA PNEUMATIC VALVE

### Pneumatic tubes Dual & Single Flush:

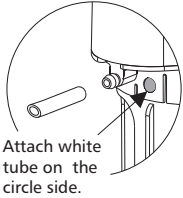

Attach white tube on the circle side.

### Dual Flush Only:

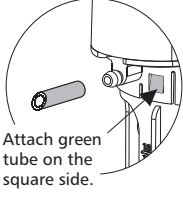

Attach green tube on the square side.

### Replacing existing Niagara pneumatic valves

**Important:** Turn off water supply to cistern

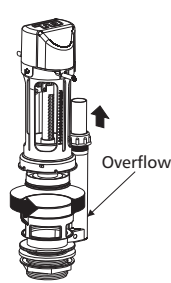

1. On the replacement valve rotate the valve anti-clockwise to unlock and pull to remove from overflow. Discard overflow if not required.

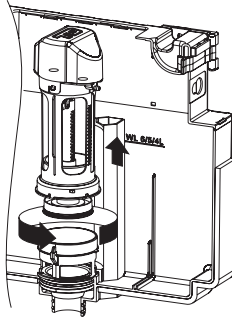

2. Remove the old valve by rotating the valve anticlockwise to unlock and pull to remove from overflow.

3. Reverse the process with the new valve. Rotate clockwise to lock in position.

**Note:** If the float has become detached from the inner stem, reattach into position 3 marked on the side of the valve. Rotate float to secure into corresponding notch.

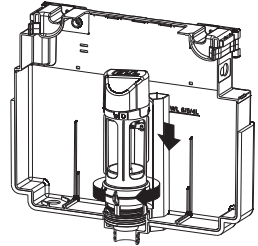

4. Reattach the pneumatic tubes to the service cover (Dudley Vantage) or flush actuator i.e. push button.
5. Turn water supply back on and test flushing works correctly.

### Replacing existing Dudley Niagara Pneumatic valves in a Royal Pushflo or other concealed cistern. Use only Dudley buttons / plates with the valve.

**Important:** Turn off water supply to cistern

1. Remove old valve from cistern.
2. Locate the Niagara valve assembly into the cistern outlet hole ensuring that the sealing washer is on the inside of the cistern.

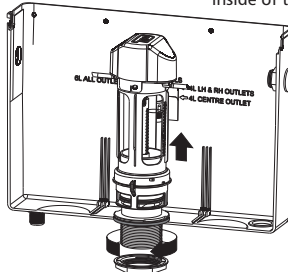

5. Turn water supply back on and test flushing works correctly.

3. Screw the back nut onto the protruding threaded tail of the Niagara assembly and hand tighten.

4. Re-attach the pneumatic tubes to the Dudley pushbutton, pushplate or Electroflo control unit.

### Replacing Flushpipe (Flushpipe not included)

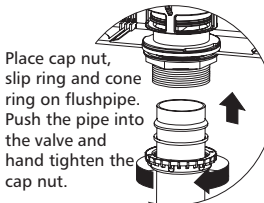

Place cap nut, slip ring and cone ring on flushpipe. Push the pipe into the valve and hand tighten the cap nut.

### Adjusting the Overflow

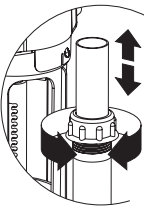

The overflow is defaulted for Dudley Cisterns however can be adjusted by loosening nut and moving pipe to suit, re-tighten after.

## 3 MAINTENANCE

1. Remove flush valve from cistern as shown in section 2.

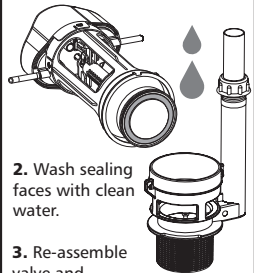

2. Wash sealing faces with clean water.

3. Re-assemble valve and ensure it is working correctly.

**Important:** Only use genuine Dudley spares or replacement parts.